

Note that all unique customer requirements (i.e tolerance) need to be verified thru Alfa Laval.

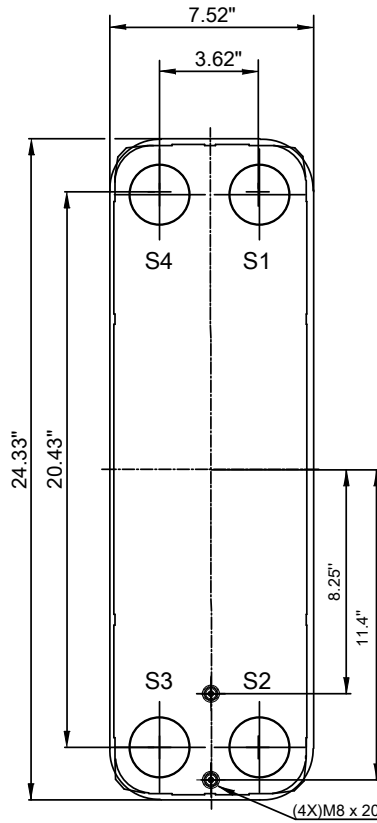
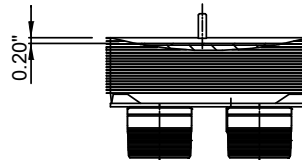
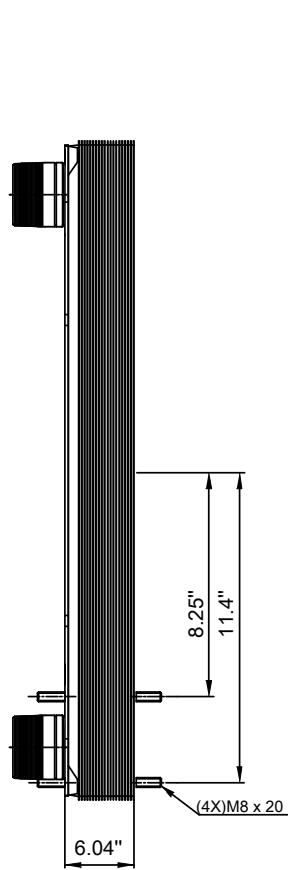
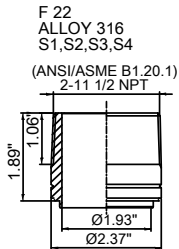

T1 T2 T3 T4 locations on back side correspond to S1 S2 S3 S4 on front side

HEATING SURFACE ft²
NETWEIGHT 68.2 lb
OPERATING WEIGHT lb
PLATE MATERIAL ALLOY 316
PLATE GROUPING 1*24H/1*25H

ALL DIMENSIONS IN INCHES

| SIDE | MEDIA | INLET | TEMP. | OUTLET | TEMP. | FLOW RATE | PRESSURE DROP | LIQUID VOL. |
|------|-------|-------|-------|--------|-------|-----------|---------------|----------------------|
| 1 | Water | S1 | °F | S2 | °F | lb/h | psi | 0.22 ft ³ |
| 2 | Water | S3 | °F | S4 | °F | lb/h | psi | 0.21 ft ³ |

PRESSURE VESSEL APPROVAL

PED/CRN

AlfaNova 76-50H (3287000889)

www.alfalaval.com

CUSTOMER NAME / REF. NO.

COMPANY / REF.
Alfa Laval Nordic AB
Alfa Laval Inc.

TOTAL LENGTH 8.5 in
TOTAL WIDTH 7.5 in
TOTAL HEIGHT 24.3 in



8/25/2021
REV 0